

APPLICATION

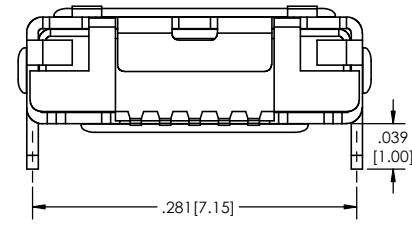
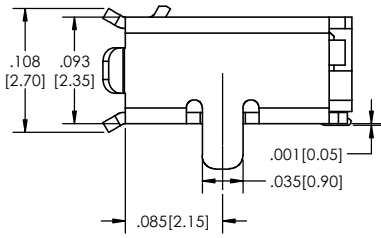
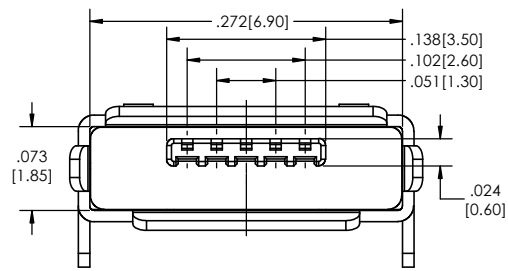
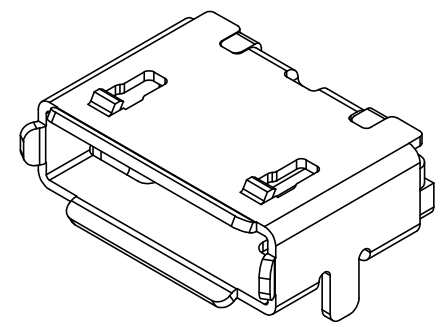
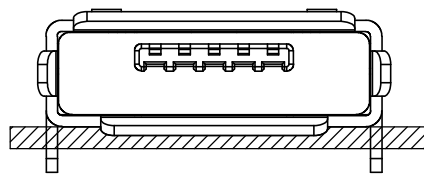

MUSB-2 **[05]** - **[OSS]** - **[H]** - **[AB]** - **[BM]** - **[TR]** - **[LF]**  
**(A)** **(B)** **(C)** **(D)** **(E)** **(F)** **(G)**

- A. Number of Contacts  
-05 Positions
- B. Mounting Options  
- OSS= Outer Shell Stakes
- C. Contact Plating  
- See Plating box below
- D. Type  
- A  
- B
- E. Mount Style  
- BM= Bottom Mount
- F. Packaging Options  
- TR= Tape and Reel
- G. Lead Free

Plating options	
<b>[H]</b>	30µ Gold on Contact Area/ Matte Tin on Tail

Specifications:  
 Electrical:  
 Voltage Rating: 100 V AC/DC  
 Current Rating:  
 Signal Mode: 1.0A AC/DC All Pins  
 Power Mode:  
 Signal (Pins 2, 3, 4): at 1.0A AC/DC  
 Power (Pins 1, 5) at 1.8A AC/DC  
 Contact Resistance: 30 Milliohms Max.  
 Insulation Resistance: 1000 Megohms Min.  
 Dielectric Withstanding Voltage: 500V AC/ Minute  
 Operating Temperature: -30°C to +85°C

Mechanical:  
 Mating Force: 35N Max.  
 Unmating Force: 10N Min.  
 Durability: 10,000 Cycles  
 Material:  
 Housing: LCP, UL94V-0, Black  
 Terminal: Copper Alloy  
 Shell: Stainless Steel (SUS304) T= 0.25mm  
 Finish:  
 Underplating: Nickel  
 Plating:  
 Contact Area: See Plating Options  
 Solder Tails: Gold Flash or Matte Tin  
 Metallic Shell: Matte Tin

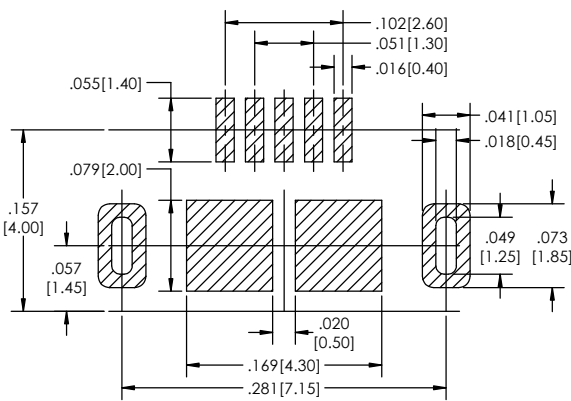

RECOMMENDED P.C.B. LAYOUT

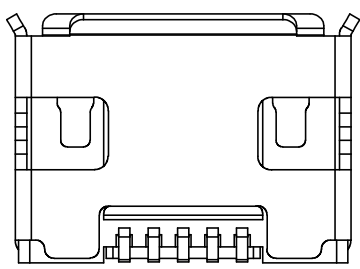

PROPRIETARY AND CONFIDENTIAL  
 THE INFORMATION CONTAINED IN THIS DRAWING IS THE SOLE PROPERTY OF Major League Electronics. ANY REPRODUCTION IN PART OR AS A WHOLE WITHOUT THE WRITTEN PERMISSION OF Major League Electronics IS PROHIBITED.

UNLESS OTHERWISE SPECIFIED:		NAME	DATE		
DIMENSIONS ARE IN INCHES		DRAWN	EOW		12/12/14
TOLERANCES: ONE DECIMALS ±.100 TWO DECIMAL ±.010 THREE DECIMAL ±.002 FOUR DECIMAL ±.002		CHECKED	GWG		12/12/14
		ENG APPR.			
		MFG APPR.			
INTERPRET GEOMETRIC TOLERANCING PER:		ADDRESS:		2533 Centennial Blvd. Jeffersonville, IN 47130 Phone: 812-670-4174 Fax: 812-670-4175 E-Mail: mle@mlelectronics.com	
MATERIAL:		FINISH:			
NEXT ASSY	USED ON	SCALE 12:1		TITLE: MUSB-205-OSS-H-AB-BM-TR-LF	
APPLICATION		DO NOT SCALE DRAWING		SIZE DWG. NO. <b>C</b>	
				REV <b>B</b>	
				SHEET 1 OF 1	